

4

3

2

1

D

D

17.8

(.700")

2.4mm Male

2.4mm Male

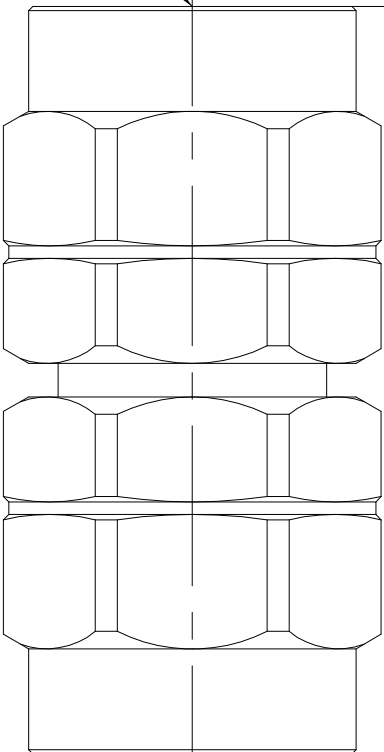

C

C

NOTES:

1.ELECTRICAL:

- 1.1 IMPEDANCE: 50Ω
- 1.2 INSULATION RESISTANCE:5000MΩ MIN
- 1.3 FREQUENCY RANGE: DC~50GHZ
- 1.4 DIELECTRIC WITHSTANDING VOLTAGE: 1000V MAX AT SEA LEVEL
- 1.5 VSWR≤1.15:1@50GHZ
- 1.6 INSERTION LOSS: 0.5dB

B

B

2.ENVIRONMENTAL:

- TEMPERATURE RANGE: -55° to +165°

3.MATERIAL AND FINISH:

- (1) BODY: STAINLESS STEEL, PASSIVATE
- (2) NUT: STAINLESS STEEL, PASSIVATE
- (3) CENTER CONTACT: BERYLLIUM COPPER, GOLD PLATING
- (4) DIELECTRIC: PTFE, N/A

A

A

THIS DRAWING IS A CONTROLLED DOCUMENT.

DIMENSIONS MM

TOLERANCES UNLESS OTHERWISE SPECIFIED:

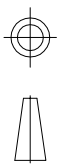

MATERIAL

FINISH

SPE TABLE

SPE TABLE

DNW DWP 25/07/2015

CHK APPD

PRODUCT SPEC

APPLICATION SPEC

WEIGHT

CUSTOMER DRAWING



Jiangsu Zdec Microwave Technology Co., Ltd.

2.4mm Male TO 2.4mm Male Adapter

SIZE: A4 CAGE CODE: 00779 DRAWING NO:

2.4mm-JJ

SCALE: 2:1

SHEET: 1

OF: 1

R/E: 1

4

3

2

1