

P	LTR	DATE	DMN	APVD
—	—	—	—	—

4

3

2

1

D

22.1

[.870"]

SW8

[.551" ACROSS

(2) FLATS]

ø9.2

[.362"]

SMA  
MALE

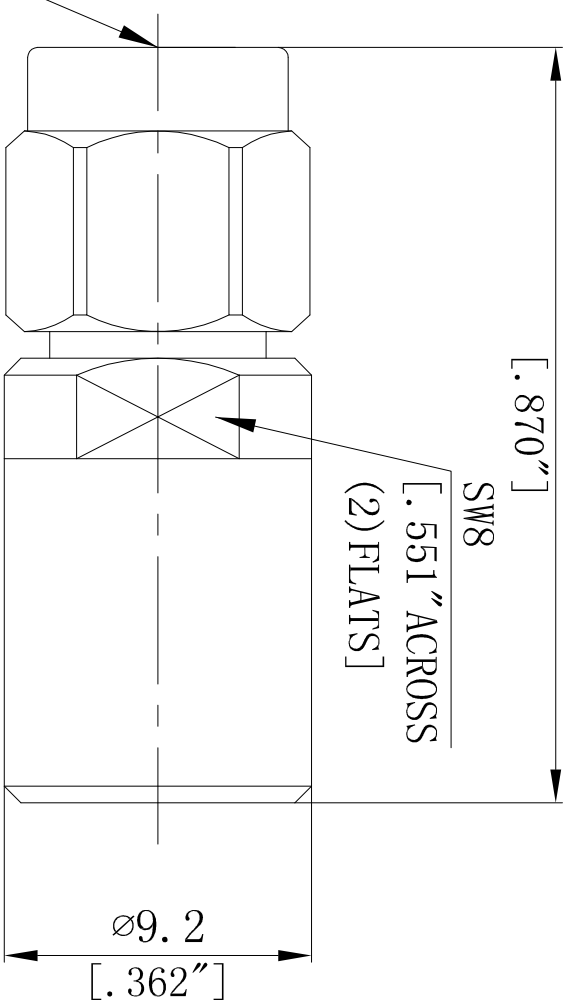

C

C

NOTES:

1.ELECTRICAL:

- 1.1 IMPEDANCE: 50Ω
- 1.2 INSULATION RESISTANCE:50000MΩ MIN
- 1.3 FREQUENCY RANGE: DC~26.5GHZ
- 1.4 DIELECTRIC WITHSTANDING VOLTAGE: 1000V MAX AT SEA LEVEL
- 1.5 VSWR≤1.30:1@26.5GHZ
- 1.6 POWER:2W

B

B

2.ENVIRONMENTAL:

- 2.1 TEMPERATURE RANGE: -55° to +165°

3.MATERIAL AND FINISH:

- 3.1 BODY: STAINLESS STEEL, PASSIVATE
- 3.2 NUT: STAINLESS STEEL, PASSIVATE
- 3.3 CENTER CONTACT: BERYLLIUM COPPER,  
GOLD PLATING
- 3.4 DIELECTRIC: PTFE, N/A

A

A

THIS DRAWING IS A CONTROLLED DOCUMENT.

DIMENSIONS MM	TOLERANCES UNLESS OTHERWISE SPECIFIED:
0 P/C ±0.25	
1 P/C ±0.15	
2 P/C ±0.12	
3 P/C ±	
4 P/C ±	
ANGLES ±1°	

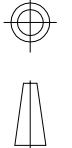

MATERIAL	FINISH	SPE TABLE
SPE TABLE		

DMN	DCJ	25/07/2017
CHK		

APVD	
PRODUCT SPEC	
APPLICATION SPEC	

WEIGHT	
CUSTOMER DRAWING	

SIZE	A4
CAGE CODE	00779
DRAWING NO	SMAJL-27-2W
SCALE	2:1
SHEET	1 OF 1
R/E	1



Jiangsu Zdec Microwave Technology Co., Ltd.

SMA Male Load

4

3

2

1